

PIPE SLEEVING SCHEDULE

PIPE SIZE	SLEEVE SIZE
1"	2"
1 1/4"	2"
1 1/2"	3"
2"	4"
2 1/2"+	6"

LEGEND	
	VALVE
	SPRAY, 360°
	SPRAY, 180°
	SPRAY, 90°
	SIDE STRIP
12	12' NOZZLE
8-10	8'-10' NOZZLE
6V	6' NOZZLE
	FLOOD BUBBLER

C IRRIGATION CONTROLLER
MOUNT TO EXTERIOR WALL IN
ACCESSIBLE AREA

RS RAIN SENSOR MOUNT CLEAR OF
OVERHAND CANOPY

DRC
PZ24-12000023
07/16/2025

IRRIGATION SYSTEM TIME SCHEDULES

SYSTEM 1
TOTAL ZONES = 2
20 MIN. PER ZONE ON
MON, WED, FRI.
TOTAL RUN TIME PER DAY = 20 MIN

NOTE:
NEW LANDSCAPE MATERIALS WILL NEED DAILY WATERING FOR A PERIOD OF 3 WEEKS
OR UNTIL ESTABLISHED. ONCE MATERIAL IS ESTABLISHED WATERING SHALL BE REDUCED
TO 2-3 DAYS A WEEK DURING STABLE WEATHER CONDITIONS.
IRRIGATION ZONE RUN TIMES ARE FLEXIBLE DEPENDING ON THE
SEASON OF YEAR AND PRECIPITATION RATES. ZONE TIMES SHALL BE
ADJUSTED PERIODICALLY TO COMPENSATE FOR NATURAL EVENTS SUCH
AS HEAVY RAIN, HIGH WIND AND DROUGHT. IRRIGATION SHOULD NOT BE RUN
DURING PERIODS OF HEAVY RAIN, HIGH WINDS OR IN CASES OF EXTREME DROUGHT.
IRRIGATION ZONES SHOULD BE RUN BETWEEN THE HOURS OF 3:00 AM AND 7:00 AM
IRRIGATION ZONES SHOULD NOT BE RUN DURING MID DAY OR EVENING HOURS.

WATERING NOTES:

WATER SCHEDULES FOR NEWLY PLANTED
TREES AND SHRUBS IN WELL DRAINED SOIL:

A RAIN SENSOR DEVICE SHALL
BE INSTALLED TO AVOID OVER WATERING OR
ROOT BALL FLOODING.
POORLY DRAINED SOILS SHALL BE MONITORED FOR
CHANGES IN MOISTURE BY CONTRACTOR OR MAINTENANCE
CREW.

RECOMMENDED GENERAL WATER QUANTITY:
2" DBH. = DAILY FOR 2 WEEKS EVERY OTHER DAY
FOR 2 MONTHS UNTIL ESTABLISHED

2"-4" DBH. = DAILY FOR 1 MONTH EVERY OTHER DAY
FOR 3 MONTHS, THEN WEEKLY UNTIL ESTABLISHED

4"+ DBH. = DAILY FOR 6 WEEKS, EVERY OTHER DAY FOR
5 MONTHS, THEN WEEKLY UNTIL ESTABLISHED.

CONTRACTOR SHALL REFERENCE IFAS #ENH857 AN ALTER
AS NEEDED PER FIELD CONDITIONS.

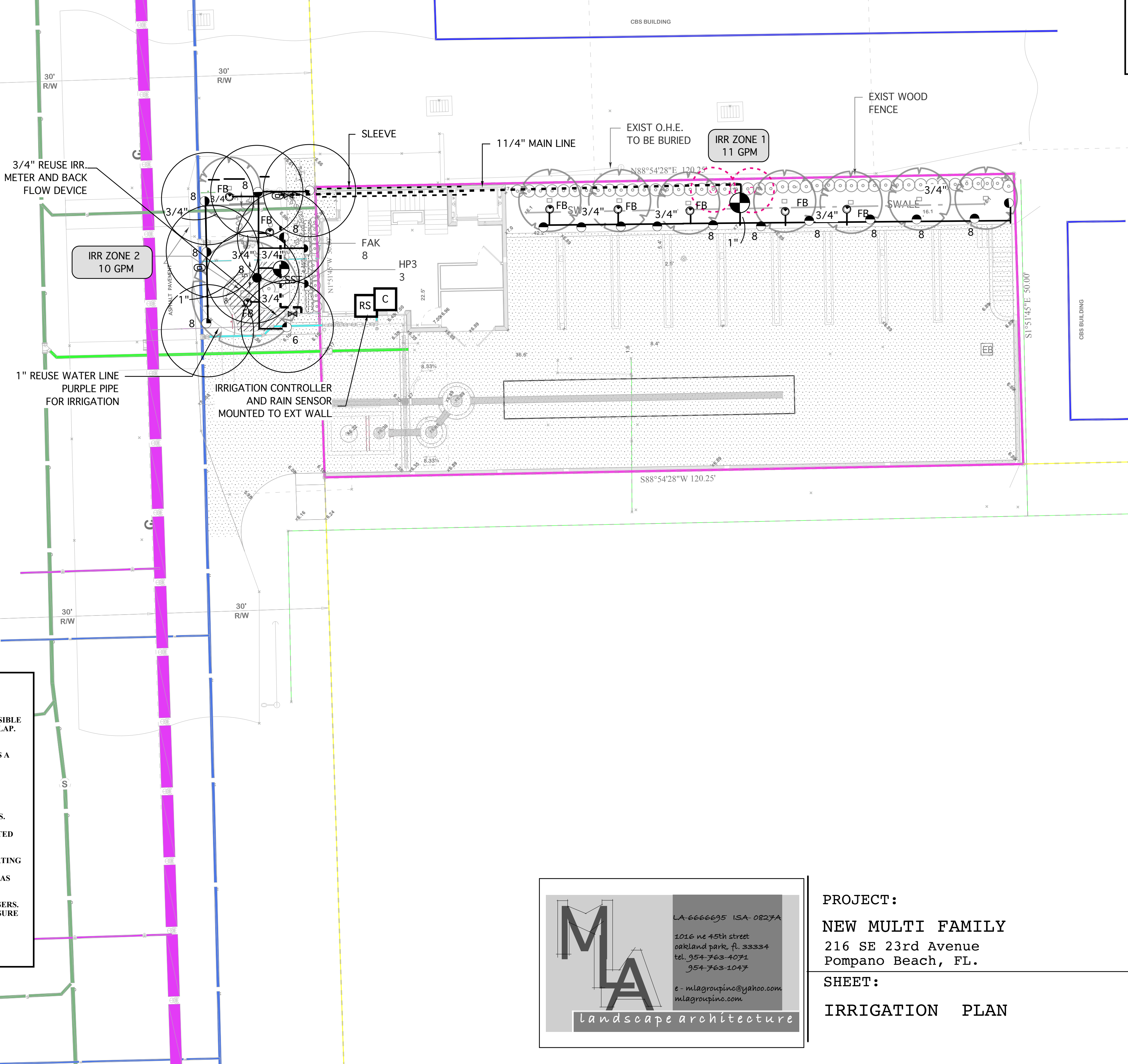

NOTE: ALL IRRIGATION EQUIPMENT SHOWN OUTSIDE OF PROPERTY LINES OR GREEN AREAS IS FOR GRAPHIC CLARITY ONLY. ALL EQUIPMENT SHALL BE INSTALLED WITHIN THE PROPERTY LINE AND WITHIN GREEN AREAS WHEREVER POSSIBLE. THE IRRIGATION DESIGN IS DRAWN FROM THE INFORMATION SUPPLIED FROM THE SITE / LANDSCAPE PLAN. THE CONTRACTOR SHALL BE RESPONSIBLE TO ENSURE ALL LANDSCAPED AREAS WILL RECIEVE 100% IRRIGATION COVERAGE WITH 100% OVERLAP. CONTRACTOR MAY ADD OR ADJUST HEADS WHERE NECESSARY TO ENSURE COVERAGE.

THE CONTRACTOR SHALL BE RESPONSIBLE TO REPAIR ANY DAMAGE DONE TO THE LANDSCAPING AS A RESULT OF IRRIGATION INSTALLATION TO EQUAL OR BETTER CONDITION.

ALL EQUIPMENT SHALL BE INSTALLED PER THE LATEST REVISED SOUTH FLORIDA BUILDING CODE APPENDIX F.

THERE SHALL BE NO MACHINE TRENCHING WITHIN THE DRIPLINE OF EXISTING OR PROPOSED TREES. ALL TRENCHES SHALL BE HAND DUG WITHIN THESE AREAS. CONTRACTOR SHALL REFER TO LANDSCAPE PLAN FOR PROPOSED AND EXISTING MATERIALS AS NOTED ON SHEETS L-1 AND L-2.

CONTRACTOR SHALL VERIFY THE LOCATIONS OF EXISTING OR PROPOSED UTILITIES PRIOR TO STARTING WORK. CONTRACTOR SHALL ADJUST EQUIPMENT WHERE NECESSARY TO AVOID CONFLICTS. CONTRACTOR SHALL SITE ADJUST ADD OR REMOVE IRRIGATION HEADS TO ENSURE ALL GREEN AREAS RECIEVE 100% COVERAGE WITH 50% OVERLAP IF SITE CONDITIONS VARY FROM THE PLAN.

IRRIGATION HEADS INSTALLED IN TALL SHRUB BEDS AND DECK PLANTERS SHALL BE PLACED ON RISERS. SEE DETAIL SHEET IR-2. RISER SHALL BE PAINTED BLACK AND ONLY BE AS TALL AS NEEDED TO ENSURE PROPER COVERAGE

CONTRACTOR SHALL UTILIZE EXITING IRRIGATION EQUIPMENT UNLESS MISSING OR IN POOR CONDITION. ALL NEW EQUIPMENT SHALL BE SPECIFIED AS NOTED ON THIS SHEET.

MLA
landscape architecture

LA-6666695 ISA-0827A
1016 ne 45th street
oakland park fl. 33334
tel. 954-763-1071
954-763-1047
e - mlagroupinc@yahoo.com
mlagroupinc.com

PROJECT:
NEW MULTI FAMILY
216 SE 23rd Avenue
Pompano Beach, FL.
SHEET:
IRRIGATION PLAN

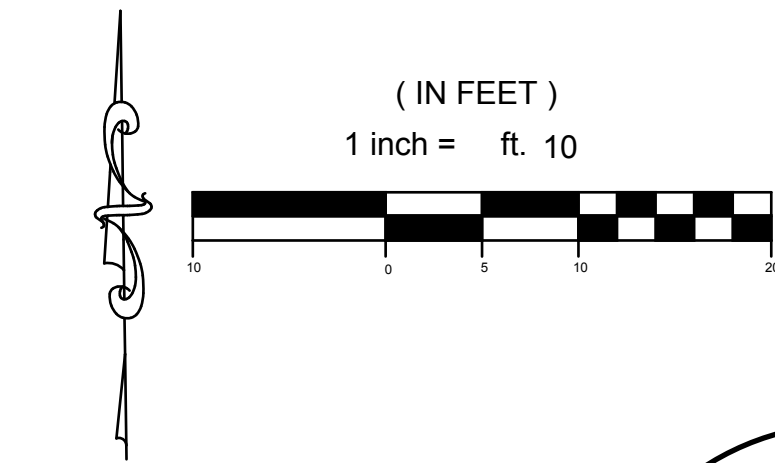

DATE: 10/9/24
SCALE: 1"=10'
SITE/DRC REV: 5/30/25